



Specialist Homelessness Services collection e-Newsletter for homelessness agencies

1 March 2019



Validata™ is ready to receive February extracts

If your November, December and January extracts have been submitted to Validata™, you can now upload and submit your February extract.



2018-19 6 month snapshot

The second quarterly snapshot for 2018-19 has been taken successfully with rates averaging 99.9% nationally. We closed the quarter recording 100% submissions from July to November 2018 and 99.7% in December 2018. This is a fantastic result!

The data collected will be used to produce future SHS reports and statistical summaries as well as providing the framework to inform Governments across Australia to fund a range of services to support people who are homeless or at risk of homelessness.



6 month Statistical Summary Reports available in March

The Statistical Summary reports for the 6 month period 1 July 2018 to 31 December 2018, are scheduled to be available to view on Validata™ by agencies and legal entities on 6 March 2019. Validata™ users with 'Reports' access can view their SHS agency Statistical Summary reports by selecting the 'Reports' tab in Validata™. If you have any queries or require assistance, please contact the SHS collection support hotline on 1800 627 191 (option 2).



Are your SHIP contact details up to date?

If you are a SHIP user, please ensure your contact information is up to date. This information is used for identification should you forget your password and to send important SHS communication.

To check and update your contact information, follow the instructions in the screenshot below

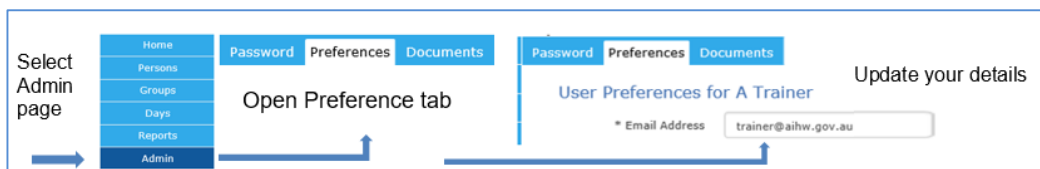



SHS webinar training

Register for a webinar now by clicking the registration links in the table below.

	Register by	Webinar date	What is covered?	Who should attend?
Validata™ Webinars Register here	20 March 2019	27 March 2pm AEDT	Basic functions within Validata™ including uploading and submitting extracts, viewing reports & user admin.	All Validata™ users
	9 April 2019	16 April 2pm AEST		
Basic Register here	7 March 2019	14 March 2pm AEDT	Opening a client support period, SHSC concepts and definitions.	Staff new to agency, staff not able to attend face to face training, new to CMS
	10 April 2019	15 April 2pm AEST		
Advanced Register here	7 March 2019	15 March 2pm AEDT	SHIP reports and lists	Managers or anyone responsible for SHS reporting
	10 April 2019	17 April 2pm AEST	Understanding and interpreting SHSC data, fixing errors in SHIP, exporting data and submitting to the AIHW	

SHS concepts and basic data entry eLearning modules can be found [here](#)

Additional eLearning modules and resources can be found on the [AIHW website](#)

